

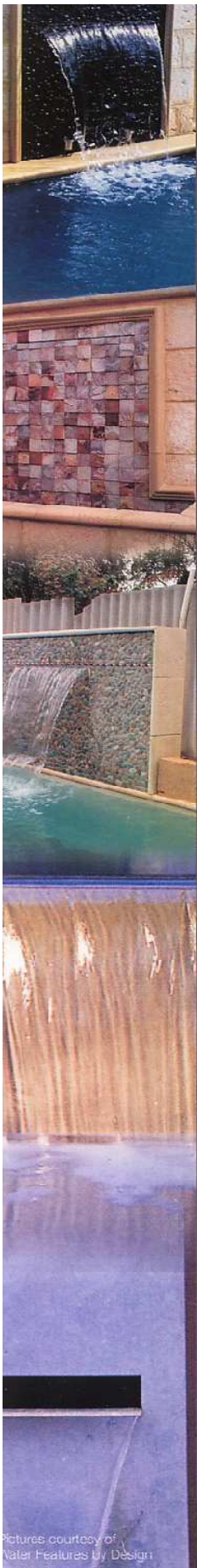

# Stainless Steel Waterwall Troughs



## HOW TO INSTALL Water Fall Type

Type 304 S/S  
Type 316 (for salt water or heavy chlorine)  
Copper also available

**Inlet size:** normally 32mm  
**No of Inlets:** <600mm x 1; <1800mm x 2; 2400mm x 3  
**Flow rate:** 120 - 150 litres per minute per metre for correct flow at the height of the trough.  
**Length:** made to order.  
Lid and seal optional extra  
Normally water will project approx. 200mm.

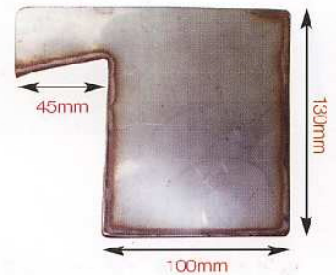
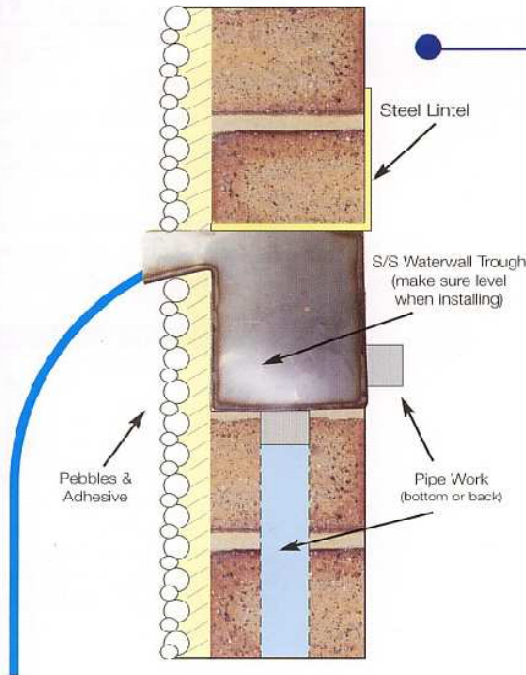

## HOW TO INSTALL Water Wall Type

Type 304 S/S  
Type 316 (for salt water or heavy chlorine)  
Copper also available

**Lip size:** made to order. (normally 10mm & 5mm kick)  
**Inlet size:** normally 25mm  
**No of Inlets:** <600mm x 1; <1800mm x 2; <2400mm x 3  
**Flow rate:** 50 litres per minute per metre for correct flow at the height of the trough.  
**Length:** made to order.  
Lid and seal optional extra

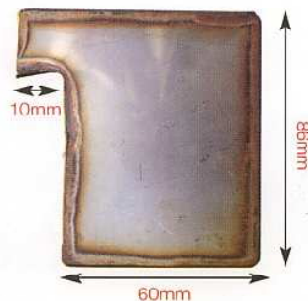
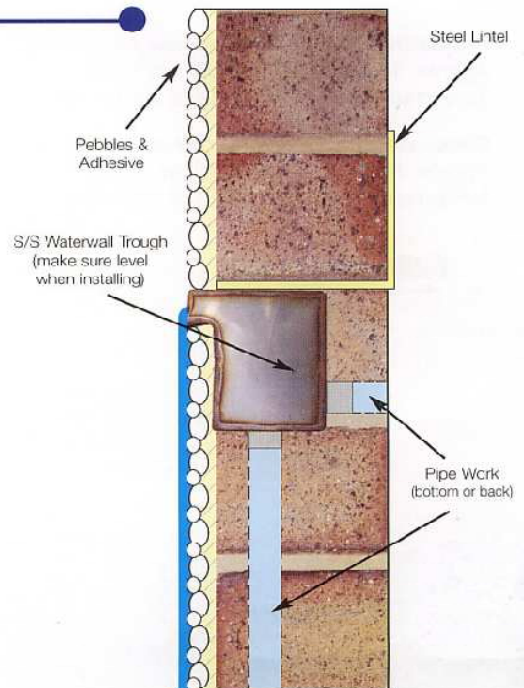

Pictures courtesy of Water Features by Design